

# SURESH MEHTA ASSOCIATES

K-6, Birbal Marg, Jangpura Extension, New Delhi – 110 014  
 Tel.: 0091-11-24310451; Telefax: 0091-11-41823347  
 e-mail: info@sureshmehta.com; H. Page: http://www.sureshmehta.com

Date: \_\_\_\_\_ S. No. \_\_\_\_\_

Deptt.: **GEAR GRINDING**

Contact Person: \_\_\_\_\_

Designation: \_\_\_\_\_

**Customer's Name & Address:** \_\_\_\_\_

\_\_\_\_\_

\_\_\_\_\_

\_\_\_\_\_

Tel.: \_\_\_\_\_

Fax: \_\_\_\_\_

e-mail: \_\_\_\_\_

\_\_\_\_\_

\_\_\_\_\_

**MACHINE** (Name & Model) \_\_\_\_\_; No. Of M/Cs \_\_\_\_\_ Nos.

Wheel Head Power: \_\_\_\_\_ KVA/KW/HP; Wheel RPM: \_\_\_\_\_; Surface speed \_\_\_\_\_ m/s

Coolant: \_\_\_\_\_; Rolling Speed: \_\_\_\_\_ mm/min; D. Strokes: \_\_\_\_\_ Nos./min

**GRINDING WHEEL** (in use) Dimensions: \_\_\_\_\_; Pr. Angle: \_\_\_\_\_ deg.

Grading: \_\_\_\_\_; Brand: \_\_\_\_\_; Annual Potential: \_\_\_\_\_ Nos.

**JOB:** (Gear/ Pinion); Matl. Composition: \_\_\_\_\_; Hardness: \_\_\_\_\_ HRC

Module: \_\_\_\_\_; No. of Teeth: \_\_\_\_\_; Face Width: \_\_\_\_\_ mm; Helix Angle: \_\_\_\_\_ deg.

Finish Reqd.: \_\_\_\_\_ um; DIN quality reqd.: \_\_\_\_\_; Grinding Allowance/ flank: \_\_\_\_\_ mm

**GRINDING DATA** (present/ recommended)

No. of Cuts →	1	2	3	4	5	6	7	8
OPERATIONS ↓								
Rolling/ Generating Speed								
No. of double strokes/ min								
Dressing / No. of teeth								
In-feed / flank								
Mot reduction								
Effect of Abrasion (%)								
Grinding Time (hrs.)								

**Remarks:**

**Gear Accuracy:** (Y/ N); **Surface Cracks:** (Y/ N); **Burn Marks:** (Y/ N); **Surface finish:** (OK/ NO)

**Production/ wheel:** \_\_\_\_\_; **Any other Observation/ Suggestion:** \_\_\_\_\_

\_\_\_\_\_

\_\_\_\_\_

**Prepared By**

**Name:** \_\_\_\_\_; **Designation:** \_\_\_\_\_; **Signature:** \_\_\_\_\_

# GEAR GRINDING WHEEL DIMENSIONS

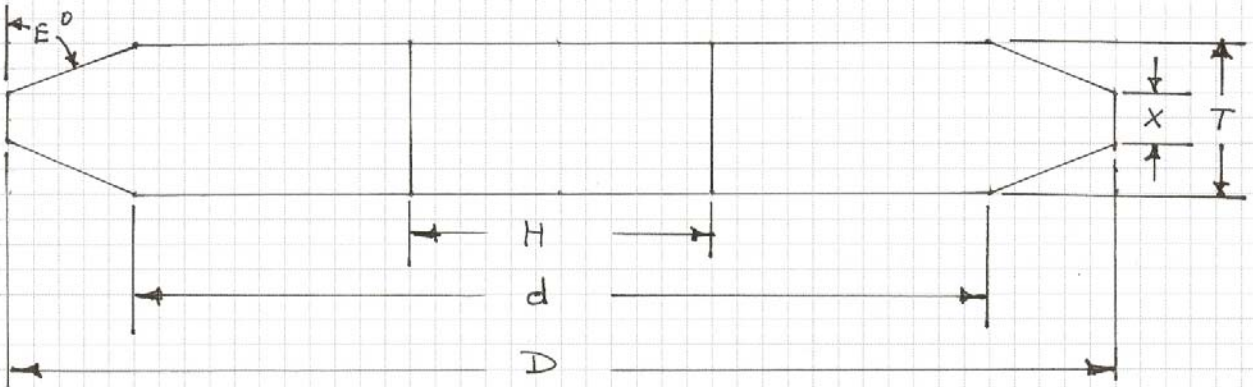

S.No.	D	d	T	X	H	E
1						
2						
3						
4						
5						